

PL84 Pilot Regulators

The PL84 is designed as a pilot for medium and small commercial sized regulators when improved accuracy is desirable. The PL84 is equipped with a convoluted diaphragm to increase sensitivity. The PL84 is a constant bleed regulator available in low, medium, and high gain to modify the response time and build up pressures.

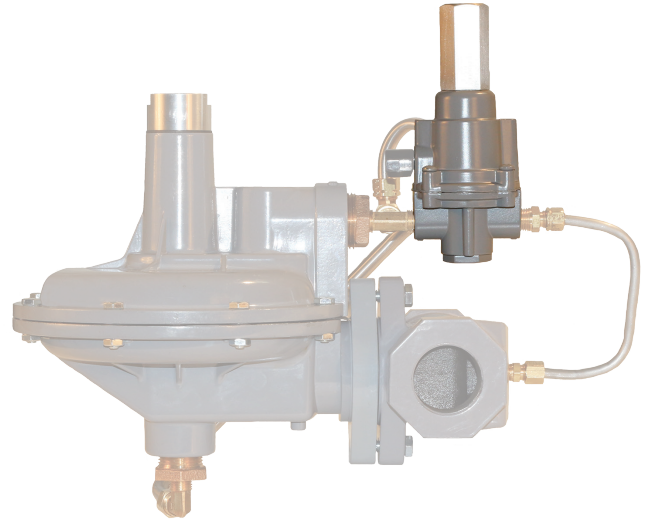

PL84 Pilot Matrix (For F300 Regulator)

PL	002				0	00	
		↑	↑	↑	↑	↑	Version
84							PSI & WC Units
							Spring Range - PSIG / BAR
	010						2-10 / 0.13-0.69
	020						2-20 / 0.13-1.38
							Bleed Restrictions
		L					Low Gain
		S					Standard Gain
		H					High Gain
							Trim
				0			Nirile (NBR)
				2			Fluorocarbon (FKM)
							Body Material
					0		Aluminum

PL84 Pilot Matrix (For F300 Regulator)

PL	002				0	00	
		↑	↑	↑	↑	↑	Version
84							PSI & WC Units
							Spring Range - WC or PSI / BAR
	014						4-14" WC / .009-0.03
	002						14"-2 PSI / 0.03-0.13
	010						2-10 PSI / 0.13-0.69
							Bleed Restrictions
		L					Low Gain
		S					Standard Gain
		H					High Gain
							Trim
				0			Nirile (NBR)
				2			Fluorocarbon (FKM)
							Body Material
					0		Aluminum

PL84 Parts

Item	Description
1	Tamperproof Nut
2	Adjustment Screw Assembly
3	Bonnet
4	Upper Spring Guide
5	Range Spring
6	Exhaust Filter
7	Body
8	Inlet Screen
9	Pintle Bushing
10	Bottom Plug
11	O-Ring
12	Pintle Spring
13	Pintle
14	Restrictor Screw
15	Diaphragm Assembly
16	Build Screws (Not Shown)

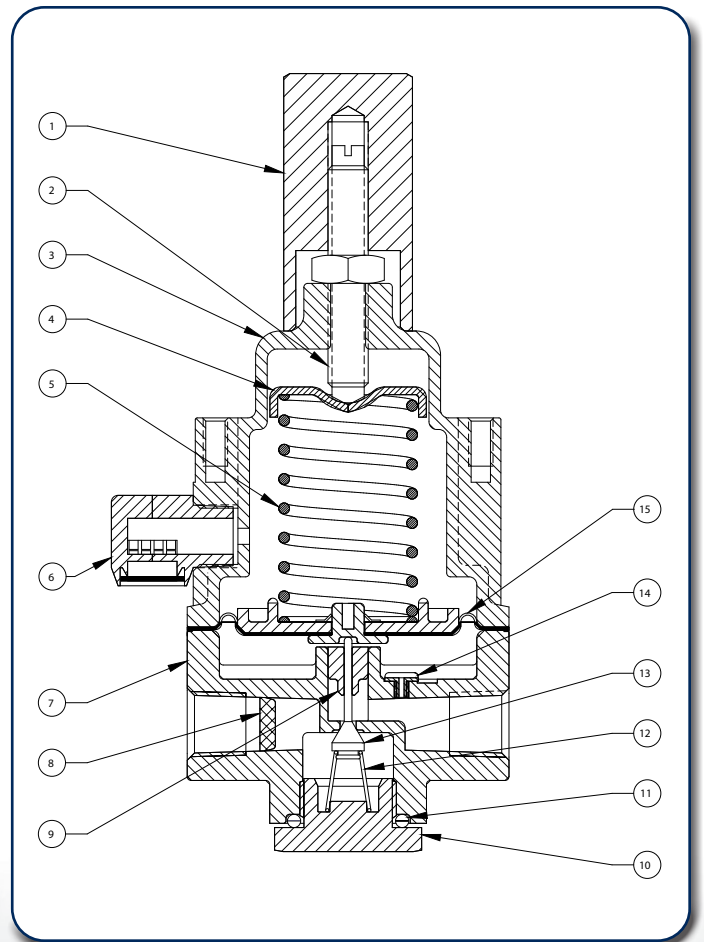

Replacement Parts

Range Springs	
4-14" W.C.	655-765-000
14" W.C. - 2 PSIG	655-749-000
2-10 PSIG	655-000-202
2-20 PSIG	655-000-267
Diaphragm Assembly	
Nitrile	804-292-000
Restrictor Screws	
Standard Gain	648-543-000
Low Gain	648-543-001
High Gain	648-543-002