

P52 Stainless Steel Regulator and Filter/Regulator

Features

- Low Droop
- Tapped Vent
- Excellent Stability
- Port Sizes from 1/4" up to 1"

Applications

- Sour Gas
- Corrosive Environments
- Off Shore

The P52SS regulator is designed for service with a wide variety of corrosive gases and severe environments. It is the ideal choice for sour gas applications and where a corrosive environment is present.

The standard version of this regulator is relieving with no constant bleed. You must specify if a non-relieving regulator is required.

Key components to the filter / regulator include a built in dripwell, 25 micron stainless filter. Both the regulator and filter / regulator come standard with Viton elastomers and a 'T' handle adjustment.



Specifications

Maximum Inlet Pressure	425 PSIG
Outlet Ranges	3 - 30 PSIG
	6 - 60 PSIG
	12 - 125 PSIG
	15 - 150 PSIG
Repeatability	± 0.25 PSIG
Flow Rates at 100 PSIG Inlet 20 PSIG Outlet	1/4" - 38 SCFM
	3/8" - 42 SCFM
	1/2" - 95 SCFM
	3/4" - 105 SCFM
	1" - 105 SCFM
Temperature Range	-4 to 176 °F
Exhaust Capacity	0.1 SCFM
Max Air Consumption	0.5 SCFH
Filter	25 Micron
Supply Pressure Sensitivity at 25 PSIG	± 1.0 PSIG Change in Output
Material	316 SS Housing Body and Filter, Viton Elastomers

P52SS Part Matrix

P052SS					
	↑	↑	↑	↑	Style
	RX				Regulator
	FR				Filter Regulator with Manual Drain
	AR				Filter Reg with Auto Drain
					Body Size
		02			1/4 NPT
		03			3/8 NPT
		04			1/2 NPT
		06			3/4 NPT
		08			1 NPT
					Output Ranges
		030			3 - 30 PSIG
		060			6 - 60 PSIG
		125			12 - 125 PSIG
		150			15 - 150 PSIG
					Options
		00			Standard
		0B			Non-relieving
		0F			5 Micron Filter
		BF			Non-relieving & 5 Micron Filter
		OH			Hex Head Adjustment
		BH			Non-relieving Hex Head Adjustment
		FH			5 Micron Filter and Hex Head
		CC			Non-relieving Hex Head and 5 Micron Filter

Mounting Bracket

607-309-000

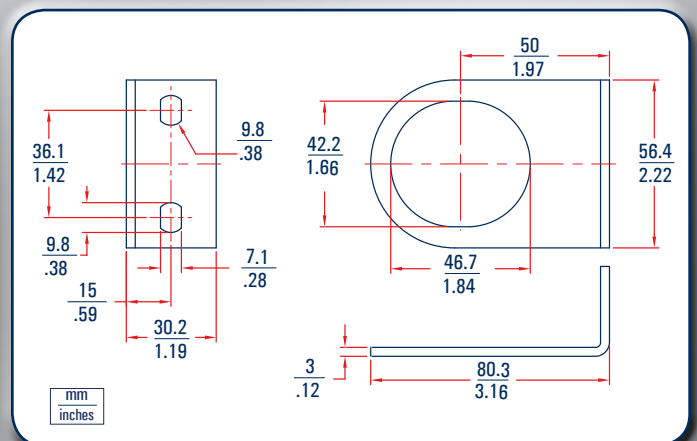

P52 Stainless Steel Dimensions

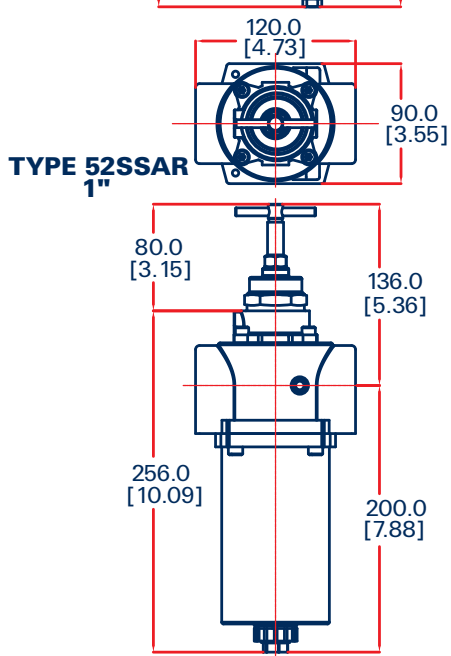
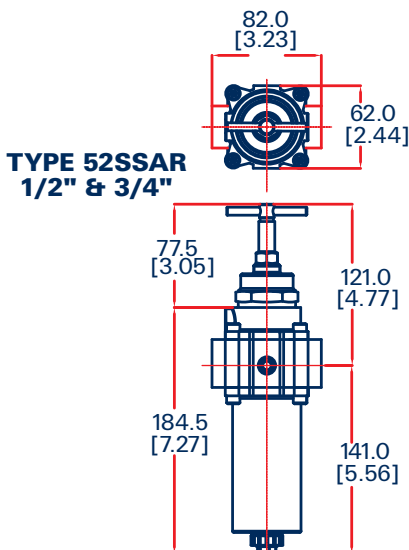
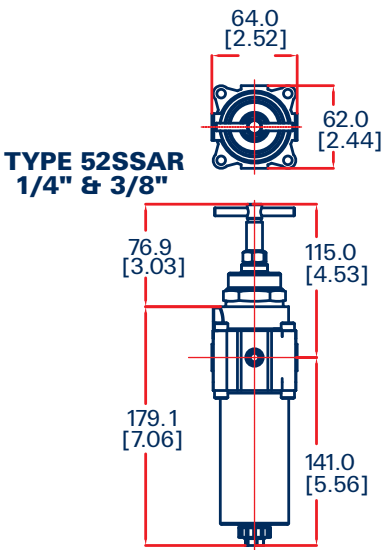
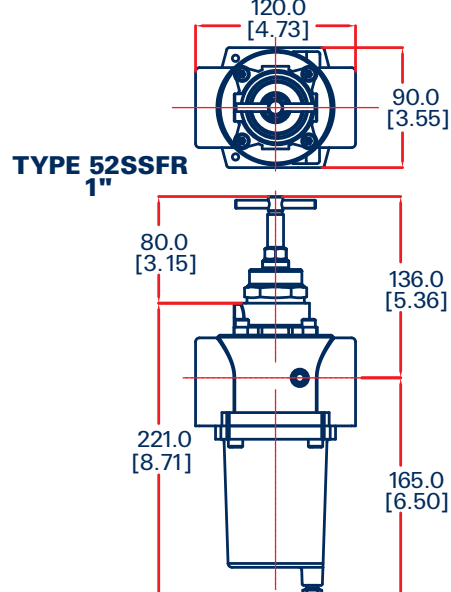
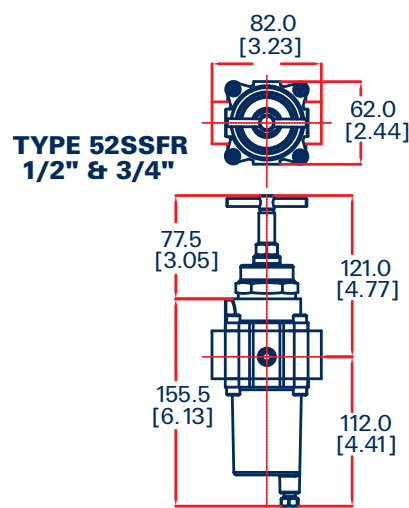
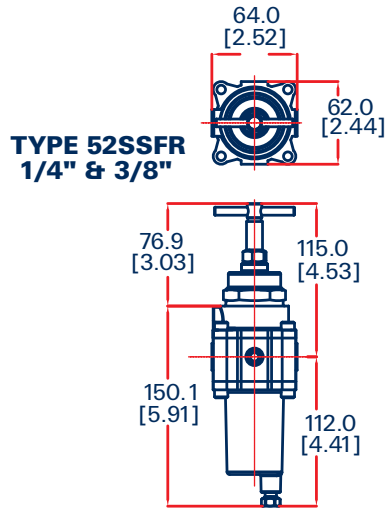
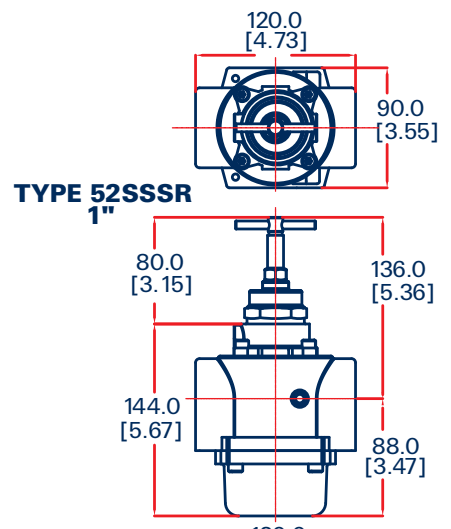
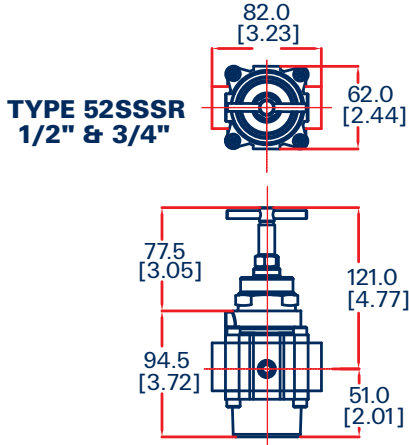
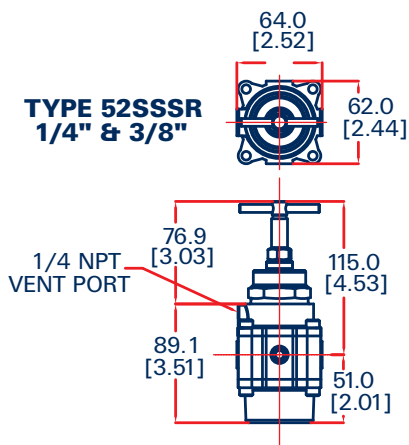

mm
inches